

Alameda County

Forsyth County

Rockingham County

Randolph County

Sheet
No. 2

GUILFORD COUNTY
NORTH CAROLINA

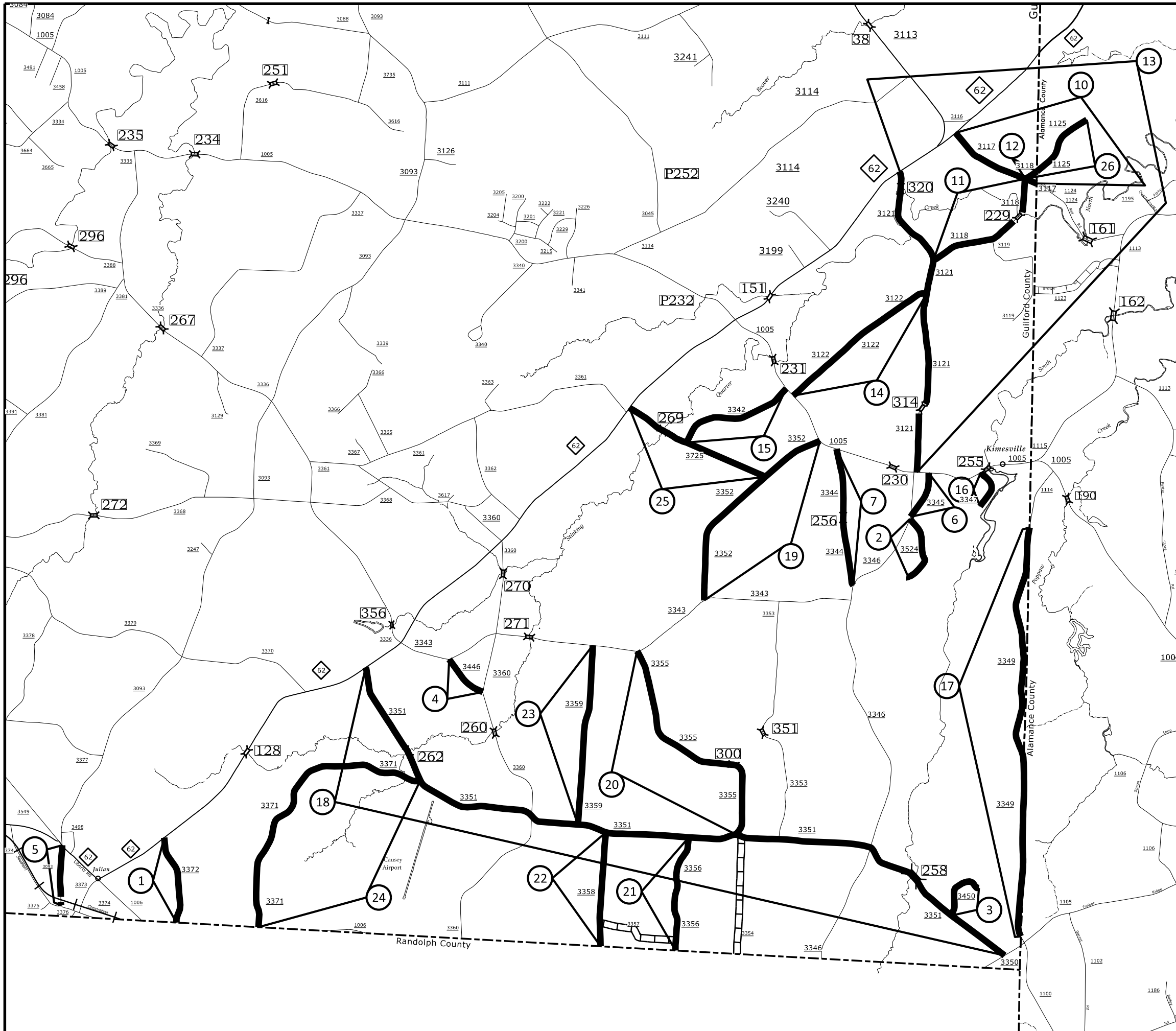

PROJECT REFERENCE NO.	SHEET NO.
2024CPT.07.08.20012 2024CPT.07.08.20412	2
Map 1	SR 3372 - Bulb Rd
Map 2	SR 3524 - Dusty Rd
Map 3	SR 3450 - Chaseford Rd
Map 4	SR 3446 - Rip Rd
Map 5	SR 3093 - Old Julian Rd Pave to the existing RxR joints and skip the Rail
Map 6	SR 3345 - Black Rd
Map 7	SR 3344 - Lineberry Rd Resurface Bridge #256 Must Adhere to Posting
Map 8	MAP REMOVED
Map 9	MAP REMOVED
Map 10	SR 3117 - Spoon Rd/Stafford Mill Rd
Map 11	SR 3118 - Shatterly Rd Do Not Resurface Bridge #229
Map 12	SR 3118 - Cobb Rd
Map 13	SR 3121 - Ferguson Rd Do Not Resurface Bridge #314 Must Adhere to Posting Resurface Bridge #320
Map 14	SR 3122 - Garrett Store Rd
Map 15	SR 3342 - Sawyer Rd
Map 16	SR 3347 - Kimesville Lake Loop
Map 17	SR 3349 - Alamance County Line Rd
Map 18	SR 3351 - Smithwood Rd Resurface Bridge #258 and #262 Skip Bowman Dairy Rd and Kimesville Rd
Map 19	SR 3352 - Beulah Church Rd
Map 20	SR 3355 - Layton Rd Resurface Bridge #300
Map 21	SR 3356 - Lowe Mail Rd
Map 22	SR 3358 - Lake Juno Rd
Map 23	SR 3359 - Staley Lake Rd
Map 24	SR 3371 - Bobby Jean Rd
Map 25	SR 3725 - Phillippi Rd Resurface Bridge #269 Must Adhere to Posting
Map 26	SR 1125 - Cobb Rd CHARGE TO 2024CPT.07.08.20012

GUILFORD COUNTY
NORTH CAROLINA

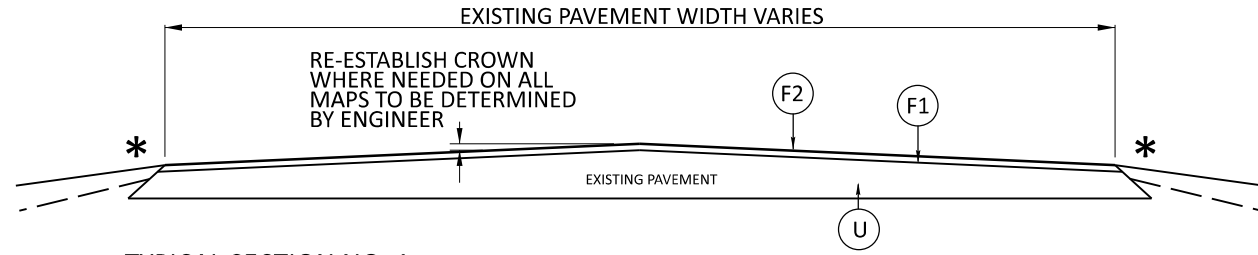

*** NOTE:**
THE SURFACE TO BE TREATED SHALL BE CLEANED TO THE SATISFACTION OF THE INSPECTOR PRIOR TO STARTING ON EACH MAP

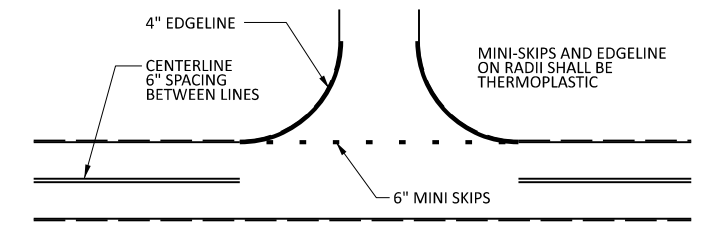

NOTE: MINI SKIPS SHALL BE PLACED ON A 8' CYCLE, CONTAINING A 6' AND 2' SKIP, THE WIDTH OF THE SKIP SHALL BE 6".

TYPICAL SECTION NO. 1

Map 1	SR 3372 - Bulb Rd	Map 14	SR 3122 - Garrett Store Rd
Map 2	SR 3524 - Dusty Rd	Map 15	SR 3342 - Sawyer Rd
Map 3	SR 3450 - Chaseford Rd	Map 16	SR 3347 - Kimesville Lake Loop
Map 4	SR 3446 - Rip Rd	Map 17	SR 3349 - Alamance County Line Rd
Map 5	SR 3093 - Old Julian Rd	Map 18	SR 3351 - Smithwood Rd
Map 6	SR 3345 - Black Rd		Resurface Bridge #258 and #262
Map 7	SR 3344 - Lineberry Rd		Skip Bowman Dairy Rd and Kimesville Rd
	Resurface Bridge #256	Map 19	SR 3352 - Beulah Church Rd
	Must Adhere to Posting	Map 20	SR 3355 - Layton Rd
Map 8	MAP REMOVED		Resurface Bridge #300
Map 9	MAP REMOVED	Map 21	SR 3356 - Lowe Mail Rd
Map 10	SR 3117 - Spoon Rd/Stafford Mill Rd	Map 22	SR 3358 - Lake Juno Rd
Map 11	SR 3118 - Shatterly Rd	Map 23	SR 3359 - Staley Lake Rd
	Do Not Resurface Bridge #229	Map 24	SR 3371 - Bobby Jean Rd
Map 12	SR 3118 - Cobb Rd	Map 25	SR 3725 - Phillippi Rd
Map 13	SR 3121 - Ferguson Rd		Resurface Bridge #269
	Do Not Resurface Bridge #314	Map 26	Must Adhere to Posting
	Must Adhere to Posting		SR 1125 - Cobb Rd
	Resurface Bridge #320		CHARGE TO 2024CPT.07.08.20012

**TO BE USED AT ALL
NON-SIGNALIZED INTERSECTIONS
(NOT TO SCALE)**

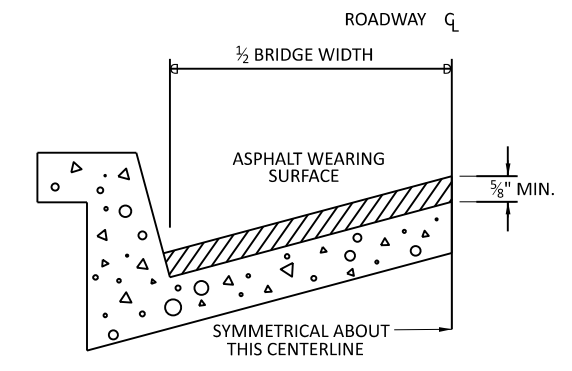

BRIDGE HALF TYPICAL SECTION

FOR BRIDGES WITH FLOOR DRAINS, CARE SHALL BE EXERCISED IN PLACING THE WEARING SURFACE AROUND FLOOR DRAINS SO AS NOT TO HINDER EFFECTIVE DRAINAGE. ALL DRAINS SHALL BE LEFT OPEN. THE PROPOSED WEARING SURFACE SHALL VARY IN THICKNESS AS NECESSARY TO PROVIDE A SMOOTH RIDING SURFACE. A THICKNESS OF NOT LESS THAN $\frac{3}{8}$ " SHALL BE PROVIDED. THE MAXIMUM THICKNESS SHALL PREFERABLY BE 1-1/2" UNLESS IT IS IMPRACTICAL TO PROVIDE A SMOOTH RIDING SURFACE OTHERWISE.

NOTES
ALL UNPAVED S.R. ROUTES TO BE SURFACED 50' FROM EDGE OF PAVEMENT OF MAIN PROJECT.
ALL PAVED S.R. ROUTES TO BE RESURFACED TO END OF RADDII, OR AS DIRECTED BY THE ENGINEER. EDGES, PAVEMENT WIDENING, INTERSECTIONS AND BRIDGE FLARES ARE INCLUDED IN THE SUMMARY OF QUANTITIES. BRIDGES TO BE RESURFACED AT LOCATIONS AND DEPTH AS DIRECTED BY THE ENGINEER.

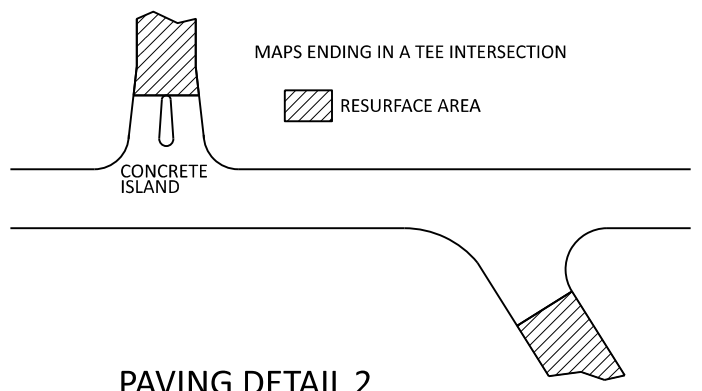

**PAVING DETAIL 2
MAIN LINE NOT BEING RESURFACED**

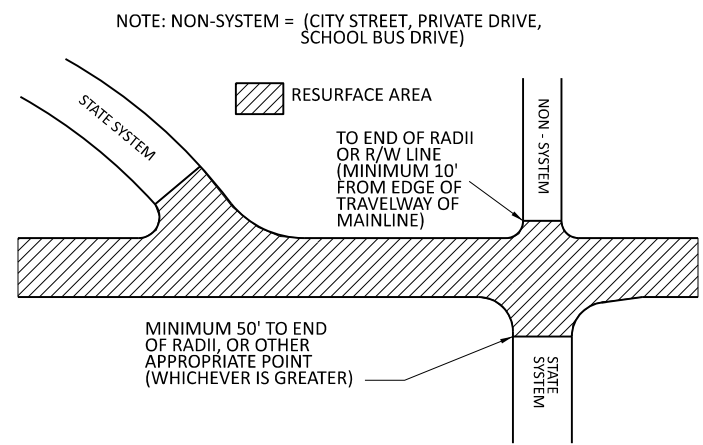

**PAVING DETAIL 1
MAIN LINE IS BEING RESURFACED**

PAVEMENT SCHEDULE	
F1	PROPOSED ASPHALT SURFACE TREATMENT, DOUBLE SEAL
F2	PROPOSED FOG SEAL
U	EXISTING PAVEMENT

SIGNING FOR ASPHALT SURFACE TREATMENT

LEGEND

- ◀ PORTABLE SIGN
- ┃ STATIONARY SIGN
- DIRECTION OF TRAFFIC FLOW

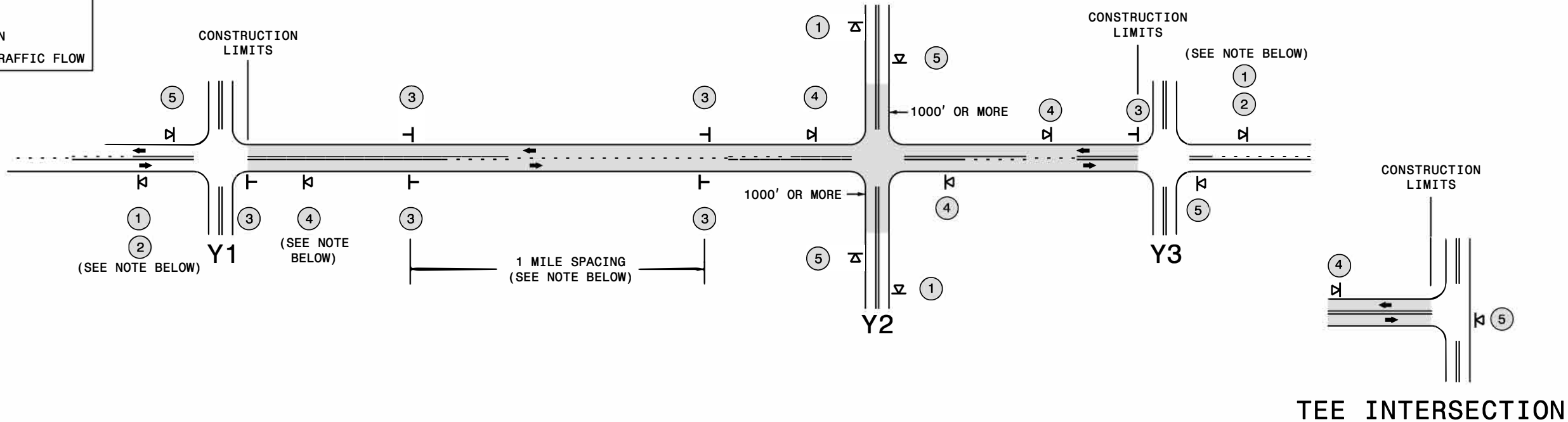

MAINLINE (-L-) SIGNING

-Y- LINE SIGNING

SIGNING NOTES AND PLACEMENT PER DIRECTION	<p>① ROAD WORK AHEAD W20-1 48" X 48"</p> <p>② NEXT XX MILES W7-3aP 24" X 18"</p> <p>③ LOOSE GRAVEL W8-7 48" X 48"</p> <p>UNMARKED PAVEMENT SP 48" X 48"</p> <p>④ ROAD UNDER CONST SP 13106 48" X 48"</p> <p>⑤ END ROAD WORK G20-2 A 48" X 24"</p>	<p>- PLACE 1000' PRIOR TO BEGINNING OF CONSTRUCTION LIMITS. ONLY USED ON -Y- LINES IF RESURFACING LIMITS EXTEND 1000' ALONG -Y- LINE.</p> <p>- SIGN #2 ONLY USED WHEN RESURFACING LIMITS ARE 2 OR MORE MILES IN LENGTH. ROUND UP TO THE NEAREST WHOLE NUMBER. DO NOT USE FRACTIONAL OR DECIMAL NUMBERS.</p> <p>- ALTERNATE THE FOLLOWING TWO SIGNS:</p> <p>- STARTING WITH "LOOSE GRAVEL" (W8-7) FOLLOWED BY "UNMARKED PAVEMENT".</p> <p>- PLACE INITIALLY AT THE CONSTRUCTION LIMITS AND SPACED 1 MILE APART THEREAFTER.</p> <p>- AT TEE INTERSECTIONS INSTALL INITIALLY 0.5 MILE FROM INTERSECTION AND SPACE 1 MILE APART THEREAFTER.</p> <p>- THESE ARE FOR -Y- LINES THAT ARE "THROUGH" ROADWAYS. DEAD END AND SUBDIVISION ROADS ARE NOT "THROUGH" ROADWAYS.</p> <p>- INSTALL 500' +/- FROM EACH -Y- LINE APPROACH AS SHOWN ABOVE.</p> <p>- FOR MULTIPLE -Y- LINES THAT ARE SEPARATED BY 0.25 MILES OR LESS, TREAT AS A SINGLE UNIT AND INSTALL WITHIN 500' OF EACH APPROACH.</p> <p>- A MAXIMUM OF 2 SIGN SETS PER MILE. DO NOT INSTALL WHEN -Y- LINES ARE WITHIN 0.5 MILES FROM "END ROAD WORK" SIGN.</p> <p>PLACE 500' FOLLOWING THE END OF CONSTRUCTION LIMITS OR AS SHOWN WHEN WORK ENDS AT A 3-WAY TEE INTERSECTION.</p>	<p>STATIONARY SIGNING NOT REQUIRED FOR THE FOLLOWING -Y- LINE CONDITIONS:</p> <ol style="list-style-type: none"> 1) LESS THAN 1000' OF RESURFACING ALONG -Y- LINE 2) SUBDIVISION ROADS 3) DEAD END ROADS <p>WHEN PAVING/CONSTRUCTION ACTIVITIES PROCEED ACROSS AN UNSIGNED -Y- LINE, PORTABLE ADVANCE WARNING SIGNS SHALL BE USED ALONG THE -Y- LINE AS SHOWN BELOW. REMOVE UPON COMPLETION OF WORK.</p> <p>ROAD WORK AHEAD W20-1 48" X 48"</p> <p>PLACED 500' IN ADVANCE OF FLAGGER.</p> <p>ROAD WORK AHEAD W20-7 A 48" X 48"</p> <p>PLACED 250' IN ADVANCE OF FLAGGER.</p>
---	---	--	---

MAPS LESS THAN 2 MILES

THE ABOVE SIGNS ARE ALL THAT ARE REQUIRED FOR A CONTRACTOR TO BEGIN A RESURFACING CONTRACT. ANY ADDITIONAL SIGNS REQUESTED BY NCDOT DIVISIONS SHALL BE INSTALLED WITHIN 7 BUSINESS DAYS OF THE START OF CONTRACT WORK.

FOR AST RESURFACING MAPS WITH CONSTRUCTION LIMITS LESS THAN 2 MILES IN LENGTH, USE A STATIONARY "LOOSE GRAVEL" SIGN AT THE BEGINNING CONSTRUCTION LIMIT FOLLOWED BY AN "UNMARKED PAVEMENT" SIGN MIDWAY THROUGH AND AN "END ROAD WORK" SIGN AT THE END CONSTRUCTION LIMIT.



ADVANCE WARNING SIGNS FOR 2-LANE ROADWAY ASPHALT SURFACE TREATMENT

PROJECT NO.	SHEET NO.	TOTAL NO.
2024CPT.07.08.20012, 2024CPT.07.08.20412	5	5

SUMMARY OF QUANTITIES

PROJECT NO	COUNTY	MAP NO	ROUTE	DESCRIPTION	TYP NO	LENGTH	WIDTH	1803500000-E	1820000000-E	1838000000-E	1838500000-N	4413000000-E	4457000000-N	4704000000-E	4709000000-E	4720000000-E	4890000000-E	4890000000-E	4890000000-E		
								ASPHALT SURFACE TREATMENT, DOUBLE SEAL	ASPHALT SURFACE TREATMENT, FOG SEAL	EMULSION FOR ASPHALT SURFACE TREATMENT	VACUUM TRUCK	WORK ZONE ADVANCE/GENERAL WARNING SIGNING	TEMPORARY TRAFFIC CONTROL	16" X 90 M WHITE THERMO	24" X 90 M WHITE THERMO	THERMO RXR 90 MILS	4" 50 MILS HOT SPRAY THERMO (WHITE)	4" 50 MILS HOT SPRAY THERMO (YELLOW)	6" 50 MILS HOT SPRAY THERMO (WHITE)		
								MI	FT	SY	SY	GAL	WK	SF	LS	LF	LF	EA	LF	LF	LF
2024CPT.07.08.20412	Guilford	1	SR-3372 / BULB RD	FROM RANDOLPH COUNTY TO NC 62	1	0.634	19	7,062	7,062	3,884											
TOTAL FOR MAP NO. 1						0.634	19	7,062	7,062	3,884											
2024CPT.07.08.20412	Guilford	2	SR-3524 / DUSTY RD	FROM SR 3346 - KIMESVILLE RD TO DEAD END	1	0.493	18	5,277	5,277	2,902											
TOTAL FOR MAP NO. 2						0.493	18	5,277	5,277	2,902											
2024CPT.07.08.20412	Guilford	3	SR-3450 / CHASEFORD RD	FROM SR 3351 - SMITHWOOD RD TO CUL DE SAC	1	0.432	18	4,896	4,896	2,693											
TOTAL FOR MAP NO. 3						0.432	18	4,896	4,896	2,693											
2024CPT.07.08.20412	Guilford	4	SR-3446 / RIP RD	FROM SR 3360 - BOWMAN DAIRY RD TO SR 3343 - COBLE CHURCH RD	1	0.309	20	3,622	3,622	1,992											
TOTAL FOR MAP NO. 4						0.309	20	3,622	3,622	1,992											
2024CPT.07.08.20412	Guilford	5	SR-3093 / OLD JULIAN RD	FROM SR 3374 - OLD SECOND ST TO NC 62	1	0.385	21	4,748	4,748	2,612											
TOTAL FOR MAP NO. 5						0.385	21	4,748	4,748	2,612											
2024CPT.07.08.20412	Guilford	6	SR-3345 / BLACK RD	FROM SR 3346 - KIMESVILLE RD TO SR 1005 - ALAMANCE CHURCH RD	1	0.332	19	3,705	3,705	2,038											
TOTAL FOR MAP NO. 6						0.332	19	3,705	3,705	2,038											
2024CPT.07.08.20412	Guilford	7	SR-3344 / LINEBERRY RD	FROM SR 1005 - ALAMANCE CHURCH RD TO SR 3346 - KIMESVILLE RD RESURFACE BRIDGE #256, MUST ADHERE TO POSTING	1	0.958	20	11,244	11,244	6,184											
TOTAL FOR MAP NO. 7						0.958	20	11,244	11,244	6,184											
2024CPT.07.08.20412	Guilford	8	MAP REMOVED																		
TOTAL FOR MAP NO. 8																					
2024CPT.07.08.20412	Guilford	9	MAP REMOVED																		
TOTAL FOR MAP NO. 9																					
2024CPT.07.08.20412	Guilford	10	SR-3117 / SPOON RD	FROM NC 62 TO ALAMANCE COUNTY	1	0.610	20	7,156	7,156	3,936											
TOTAL FOR MAP NO. 10						0.610	20	7,156	7,156	3,936											
2024CPT.07.08.20412	Guilford	11	SR-3118 / SHATTERLY RD	FROM SR 3121 - FERGUSON RD TO SR 3117 - STAFFORD MILL RD DO NOT RESURFACE BRIDGE #229	1	0.902	20	10,578	10,578	5,818											
TOTAL FOR MAP NO. 11						0.902	20	10,578	10,578	5,818											
2024CPT.07.08.20412	Guilford	12	SR-3118 / COBB RD	FROM SR 3117 - STAFFORD MILL RD TO ALAMANCE COUNTY	1	0.007	20	78	78	43											
TOTAL FOR MAP NO. 12						0.007	20	78	78	43											
2024CPT.07.08.20412	Guilford	13	SR-3121 / FERGUSON RD	FROM SR 1005 - ALAMANCE CHURCH RD TO NC 62 DO NOT RESURFACE BRIDGE #314, MUST ADHERE TO POSTING, RESURFACE BRIDGE #320	1	2.241	20	26,289	26,289	14,459											
TOTAL FOR MAP NO. 13						2.241	20	26,289	26,289	14,459											
2024CPT.07.08.20412	Guilford	14	SR-3122 / GARRETT STORE RD	FROM SR 1005 - ALAMANCE CHURCH RD TO SR 3121 - FERGUSON RD	1	1.186	20	13,911	13,911	7,651											
TOTAL FOR MAP NO. 14						1.186	20	13,911	13,911	7,651											
2024CPT.07.08.20412	Guilford	15	SR-3342 / SAWYER RD	FROM SR 1005 - ALAMANCE CHURCH RD TO SR 3725 - PHILLIPPI RD	1	0.848	19	9,458	9,458	5,202											
TOTAL FOR MAP NO. 15						0.848	19	9,458	9,458	5,202											
2024CPT.07.08.20412	Guilford	16	SR-3347 / KIMESVILLE LAKE LOOP	FROM BEGIN MAINT TO SR 1005 - ALAMANCE CHURCH RD	1	0.280	17	2,796	2,796	1,538											
TOTAL FOR MAP NO. 16						0.280	17	2,796	2,796	1,538											
2024CPT.07.08.20412	Guilford	17	SR-3349 / ALAMANCE COUNTY LINE RD	FROM ALAMANCE COUNTY (MP 0.00) TO ALAMANCE COUNTY (MP 2.95)	1	2.950	20	34,611	34,611	19,036											
TOTAL FOR MAP NO. 17						2.950	20	34,611	34,611	19,036											
2024CPT.07.08.20412	Guilford	18	SR-3351 / SMITHWOOD RD	FROM SR 3350 - RICHLAND CHURCH RD TO NC 62 RESURFACE BRIDGE #258 AND #262, SKIP BOWMAN DAIRY RD AND KIMESVILLE RD	1	5.389	20	63,233	63,233	34,778											
TOTAL FOR MAP NO. 18						5.389	20	63,233	63,233	34,778											
2024CPT.07.08.20412	Guilford	19	SR-3352 / BEULAH CHURCH RD	FROM SR 1005 - ALAMANCE CHURCH RD TO SR 3343 - COBLE CHURCH RD	1	1.505	20	17,656	17,656	9,711											
TOTAL FOR MAP NO. 19						1.505	20	17,656	17,656	9,711											
2024CPT.07.08.20412	Guilford	20	SR-3355 / LAYTON RD	FROM SR 3351 - SMITHWOOD RD TO SR 3343 - COBLE CHURCH RD RESURFACE BRIDGE #300	1	1.720	19	19,169	19,169	10,543											
TOTAL FOR MAP NO. 20						1.720	19	19,169	19,169	10,543											
2024CPT.07.08.20412	Guilford	21	SR-3356 / LOWE MAIL RD	FROM SR 3351 - SMITHWOOD RD TO RANDOLPH COUNTY LINE	1	0.819	20	9,611	9,611	5,286											
TOTAL FOR MAP NO. 21						0.819	20	9,611	9,611	5,286											
2024CPT.07.08.20412	Guilford	22	SR-3358 / LAKE JUNO RD	FROM SR 3351 - SMITHWOOD RD TO RANDOLPH COUNTY LINE	1	0.794	20	9,311	9,311	5,121											
TOTAL FOR MAP NO. 22						0.794	20	9,311	9,311	5,121											
2024CPT.07.08.20412	Guilford	23	SR-3359 / STALEY LAKE RD	FROM SR 3343 - COBLE CHURCH RD TO SR 3351 - SMITHWOOD RD	1	1.258	20	14,762	14,762	8,119											
TOTAL FOR MAP NO. 23						1.258	20	14,762	14,762	8,119											
2024CPT.07.08.20412	Guilford	24	SR-3371 / BOBBY JEAN RD	FROM SR 3351 - SMITHWOOD RD TO RANDOLPH COUNTY	1	2.056	20	24,122	24,122	13,267											
TOTAL FOR MAP NO. 24						2.056	20	24,122	24,122	13,267											
2024CPT.07.08.20412	Guilford	25	SR-3725 / PHILLIPPI RD	FROM NC 62 TO SR 3352 - BEULAH CHURCH RD RESURFACE BRIDGE #269, MUST ADHERE TO POSTING	1	1.066	20	12,511	12,511	6,881											
TOTAL FOR MAP NO. 25						1.066	20	12,511	12,511	6,881											
TOTAL FOR PROJ NO. 2024CPT.07.08.20412						27.533		320,088	320,088	176,049											
2024CPT.07.08.20012	Alamance	26	SR-1125 / COBB RD	FROM GUILFORD CO TO DEAD END	1	0.595	18	6,696	6,696	3,683											
TOTAL FOR MAP NO. 26						0.595	18	6,696	6,696	3,683											
TOTAL FOR PROJ NO. 2024CPT.07.08.20012						0.595		6,696	6,696	3,683											
GRAND TOTAL						28.128		326,784	326,784	179,732	4		3,162	1	100	50	4	274,216	256,199	196	
																530,415					